

ANSI B16.5 Class 600 Weld-Neck Flanges

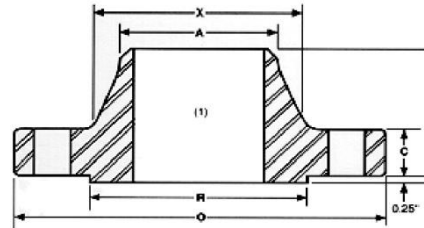

Nominal Size	Outside Diameter O	Thickness C	Dia Of Raised Face R	Dia. Of Hub At Base X	Dia. Of Hub at welding Point A	Length Thru Hub Y	No. Of Holes	Dia. of holes	Dia. Of Bolts	Dia. Of Bolt Circle	Approx. Weight (Lbs)
1/2"	3.75	0.56	1.38	1.50	0.84	2.06	4	0.62	1/2	2.62	2
3/4"	4.62	0.62	1.69	1.88	1.05	2.25	4	0.75	5/8	3.25	4
1"	4.88	0.69	2.00	2.12	1.32	2.44	4	0.75	5/8	3.50	4
1 1/4"	5.25	0.81	2.50	2.50	1.66	2.62	4	0.75	5/8	3.88	6
1 1/2"	6.12	0.88	2.88	2.75	1.90	2.75	4	0.88	3/4	4.50	8
2"	6.50	1.00	3.62	3.31	2.38	2.88	8	0.75	5/8	5.00	12
2 1/2"	7.50	1.12	4.12	3.94	2.88	3.12	8	0.88	3/4	5.88	18
3"	8.25	1.25	5.00	4.62	3.50	3.25	8	0.88	3/4	6.62	23
3 1/2"	9.00	1.38	5.50	5.25	4.00	3.38	8	1.00	7/8	7.25	26
4"	10.75	1.50	6.19	6.00	4.50	4.00	8	1.00	7/8	8.50	42
5"	13.00	1.75	7.31	7.44	5.56	4.50	8	1.12	1	10.50	68
6"	14.00	1.88	8.50	8.75	6.63	4.62	12	1.12	1	11.50	81
8"	16.50	2.19	10.62	10.75	8.63	5.25	12	1.25	1 1/8	13.75	120
10"	20.00	2.50	12.75	13.50	10.75	6.00	16	1.38	1 1/4	17.00	190
12"	22.00	2.62	15.00	15.75	12.75	6.12	20	1.38	1 1/4	19.25	225
14"	23.75	2.75	16.25	17.00	14.00	6.50	20	1.50	1 3/8	20.75	280
16"	27.00	3.00	18.50	19.50	16.00	7.00	20	1.62	1 1/2	23.75	390
18"	29.25	3.25	21.00	21.50	18.00	7.25	20	1.75	1 5/8	25.75	475
20"	32.00	3.50	23.00	24.00	20.00	7.50	24	1.75	1 5/8	28.50	590
24"	37.00	4.00	27.25	28.25	24.00	8.00	24	2.00	1 7/8	33.00	830

TECH TUBES & FITTINGS

Phone: +91-22-6743 6862 ; Email: sales@techtubes.in ; Web: www.techtubes.in

Information in this catalog was compiled from industry sources that Tech Tubes & Fitting believes to be reliable.

We, however, do not guarantee the accuracy of this data.

ALL DIMENSIONS IN INCHES